

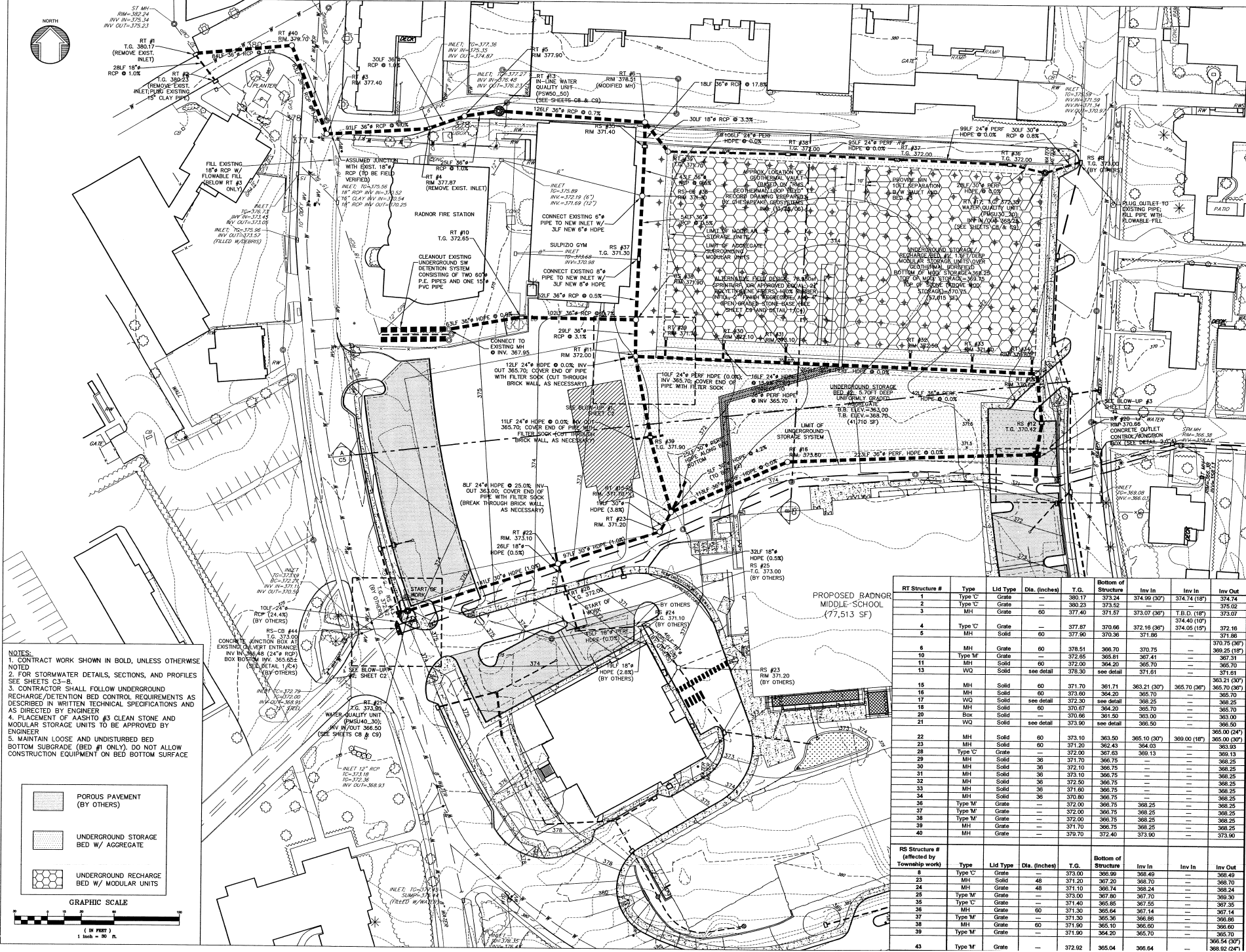

ST. MARY  
 RM=362.24  
 INV IN=375.34  
 INV OUT=375.23

RT #1  
 T.G. 380.17  
 (REMOVE EXIST. INLET)

28LF 18" RCP @ 1.0%



- NOTES:
1. CONTRACT WORK SHOWN IN BOLD, UNLESS OTHERWISE NOTED
  2. FOR STORMWATER DETAILS, SECTIONS, AND PROFILES SEE SHEETS C3-B.
  3. CONTRACTOR SHALL FOLLOW UNDERGROUND RECHARGE/DETENTION BED CONTROL REQUIREMENTS AS DESCRIBED IN WRITTEN TECHNICAL SPECIFICATIONS AND AS DIRECTED BY ENGINEER
  4. PLACEMENT OF AASHTO #3 CLEAN STONE AND MODULAR STORAGE UNITS TO BE APPROVED BY ENGINEER
  5. MAINTAIN LOOSE AND UNDISTURBED BED BOTTOM SUBGRADE (BED #1 ONLY); DO NOT ALLOW CONSTRUCTION EQUIPMENT ON BED BOTTOM SURFACE

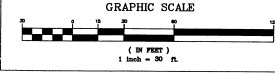
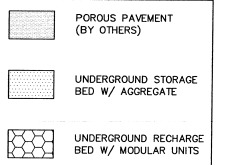

RS Structure #	Type	Lid Type	Dia. (inches)	T.G.	Bottom of Structure	Inv In	Inv In	Inv In	Inv Out
1	Type C	Grate	60	380.17	373.24	374.99 (30')	374.74 (18')	374.74	374.74
2	Type C	Grate	60	380.23	373.52	374.99 (30')	374.74 (18')	374.74	374.74
3	MH	Grate	60	377.40	371.57	373.07 (30')	T.B.D. (18')	373.07	373.07
4	Type C	Grate	60	377.87	370.66	372.16 (30')	374.40 (10')	372.16	372.16
5	MH	Solid	60	377.90	370.36	371.88	374.05 (10')	371.88	371.88
6	MH	Grate	60	378.51	368.70	370.75	370.75 (30')	370.75	370.75
10	Type M	Grate	60	372.65	365.81	367.41	---	367.41	---
11	MH	Solid	60	372.00	364.20	365.70	---	365.70	---
13	VVO	Solid	see detail	378.30	see detail	371.81	---	371.81	---
15	MH	Solid	60	371.70	361.71	363.21 (30')	365.70 (35')	363.21 (30')	365.70 (35')
16	MH	Solid	60	373.60	364.20	365.70	---	365.70	---
17	VVO	Solid	see detail	372.90	see detail	368.25	---	368.25	---
18	MH	Solid	60	370.67	364.20	365.70	---	365.70	---
20	Box	Solid	---	370.66	361.50	363.00	---	363.00	---
21	VVO	Solid	see detail	373.90	see detail	365.50	---	365.50 (24')	---
22	MH	Solid	60	373.10	363.50	365.10 (30')	369.00 (18')	365.00 (30')	369.00 (30')
23	MH	Solid	60	371.20	362.43	364.03	---	364.03	---
28	Type C	Grate	---	372.00	367.63	369.13	---	369.13	---
29	MH	Solid	36	371.70	366.75	---	---	366.75	---
30	MH	Solid	36	372.10	366.75	---	---	366.75	---
31	MH	Solid	36	373.10	366.75	---	---	366.75	---
32	MH	Solid	36	372.50	366.75	---	---	366.75	---
33	MH	Solid	36	371.60	366.75	---	---	366.75	---
34	MH	Solid	36	370.80	366.75	---	---	366.75	---
35	Type M	Grate	---	372.00	366.75	368.25	---	368.25	---
37	Type M	Grate	---	372.00	366.75	368.25	---	368.25	---
38	Type M	Grate	---	372.00	366.75	368.25	---	368.25	---
39	MH	Solid	60	371.70	366.75	368.25	---	368.25	---
40	MH	Grate	---	379.70	372.40	373.90	---	373.90	---
8	Type C	Grate	---	373.00	366.99	368.49	---	368.49	---
23	MH	Solid	48	371.20	367.20	368.70	---	368.70	---
24	MH	Grate	48	371.10	366.74	368.24	---	368.24	---
25	Type M	Grate	---	373.00	367.80	367.70	---	369.30	---
35	Type C	Grate	---	371.40	365.85	367.35	---	367.35	---
36	MH	Grate	60	371.90	365.64	367.14	---	367.14	---
37	Type M	Grate	---	371.30	365.36	366.86	---	366.86	---
38	MH	Grate	60	371.90	365.10	366.60	---	366.60	---
39	Type M	Grate	---	371.90	364.20	365.70	---	365.70	---
43	Type M	Grate	---	373.92	365.04	366.54	---	366.54 (30')	368.92 (24')

Warning: Actual Conditions may vary from conditions shown on this drawing. Confirm all information in the field before proceeding with any work and notify the Engineer in writing if a variation is discovered.

This drawing is an instrument of professional service and shall not be modified, copied or used for another project without the written consent of the Engineer.

Date	Comments
11/22/06	FOR REVIEW
1/23/07	FOR REVIEW
6/29/07	FOR BID

Scale: 1"=30'

Drawn By: SM  
 Checked By: CPW  
 Approved By: THC

Sheet No.  
**C1.0**

